



Lint Tester

The Lint Tester, developed by Domtar Research, consists of a device for collecting the lint, or other debris, from an offset blanket and a device for screening the lint for analysis.



This device provides a simple and economical means to measure and characterize lint or other offset blanket debris.

- In the press room, linting is the result of the linting propensity of the sheet and the printing press conditions.
- Lint particles on the blanket will become sufficiently numerous to noticeably degrade the quality of the printed image. This critical property can be easily measured with the Domtar Lint Tester after minimal training of personnel.

ADVANTAGES:

- Evaluate linting tendency in a commercial environment without the difficulties and delays associated with the removal of the entire blanket from the press.
- Portable and easy to use in commercial press rooms
- Complete and rapid removal of debris from a known blanket area
- Realistic results since the lint is collected after a "commercial" number of printing impressions
- Quantitative results when using the screening device
- Suitable for a wide range of commercial or laboratory printing presses
- Easy to use with minimal personnel training

Domtar Lint Tester

THE LINT COLLECTOR PRINCIPLE

Packaged in a sturdy yet small case, the self-contained collection unit has been designed to collect lint from selected areas of an offset press blanket.

The lint collector consists of a tray which is held firmly against the stationary offset blanket area to be sampled.

Using 5% aqueous isopropanol and a brush, the lint and ink are washed off the blanket into the tray and bottled. The "lint" in the bottled samples can be screened to determine the mass fractions retained on each mesh as well as being analyzed by other means.

THE SCREENING DEVICE PRINCIPLE

To simplify the lint screening procedure and to eliminate the sources of variation, a two-stage screening device is provided.

The device is constructed with spaces for one removable 150 mesh stainless steel screen in the upper chamber and one removable 400 mesh stainless steel screen in the lower chamber.

Other mesh sizes are available as options.

The larger lint material tends to be retained on the 150-mesh screen while the smaller lint material will be collected on the 400-mesh screen.

The ink pigment and smaller paper-derived material that passed through the 400-mesh screen are ignored.

The material collected on the two removable screens is weighed analytically to give a numerical value for both "large" and "small" lint.

OPTIONS

- Spare screens
- Other mesh sizes
- Custom size for the collector
- Extra sample bottles

WEIGHT (kg)

- Sample Collector Case 10 kg
- Screening Device 15 kg

DIMENSIONS (mm)

- Collector Case 450 L x 300 W x 200 H
- Screening Device 300 L x 300 W x 1000 H



The Lint Collector in the traveling case

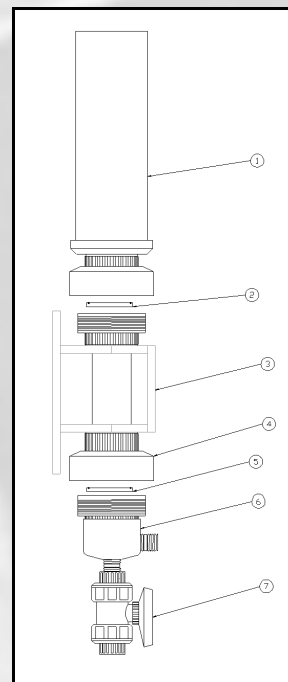

Schematic of the Screening Device



M.C. TEC

900 Tupper St.
Hawkesbury, ON Canada
K6A 3S3
P: 613-632-5169
F: 613-632-3744
E-mail: sales@optest.com

Sales and service benelux

M.C. TEC
Distributiestraat 73
4283JN Giessen, Netherlands
Phone: +31 0183 445050
www.mctec.nl | info@mctec.nl